

| DATE    | REVISIONS                                  | REV |
|---------|--|-----|
| 9-16-92 | REDRAWN, CHG'D DIA. FROM 4.8 TO 4.85 MAX./ | A   |
| 9-12-95 | REDRAWN, UPDATED SAFE OPER. SPECS./        | B   |

|                                 |          |
|---------------------------------|----------|
| DRAWING NUMBER<br>SSL-LX509F3YD | REV<br>B |
|---------------------------------|----------|

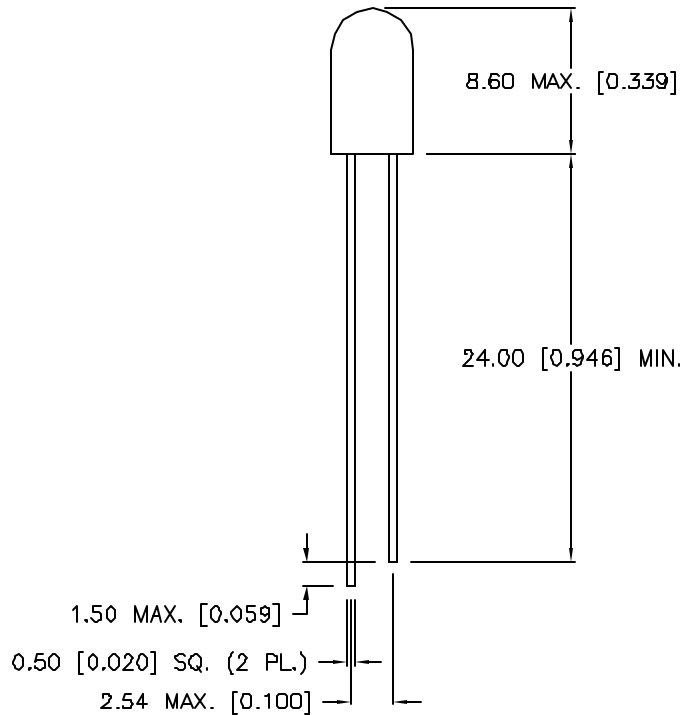
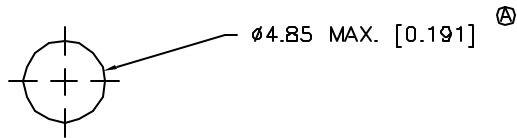

ELECTRO-OPTICAL CHARACTERISTICS  $T_A = 25^\circ\text{C}$   $I_f = 20\text{mA}$

| PARAMETER         | MIN             | TYP          | MAX | UNITS      | TEST COND              |
|-------------------|-----------------|--------------|-----|------------|------------------------|
| PEAK WAVELENGTH   |                 | 585 (YELLOW) |     | nm         |                        |
| FORWARD VOLTAGE   |                 | 2.1          | 2.8 | $V_f$      |                        |
| REVERSE VOLTAGE   | 5.0             |              |     | $V_r$      | $I_f = 100\mu\text{A}$ |
| AXIAL INTENSITY   |                 | 20           |     | mcd        | $I_f = 20\text{mA}$    |
| VIEWING ANGLE     |                 | 80           |     | $2x$ theta |                        |
| EMITTED COLOR     | YELLOW          |              |     |            |                        |
| EPOXY LENS FINISH | YELLOW DIFFUSED |              |     |            |                        |

<sup>Ⓑ</sup> LIMITS OF SAFE OPERATION AT  $25^\circ\text{C}$

| PARAMETER                      | MAX        | UNITS                |
|--------------------------------|------------|----------------------|
| PEAK FORWARD CURRENT*          | 150        | mA                   |
| STEADY CURRENT                 | 30         | mA                   |
| POWER DISSIPATION              | 105        | mW                   |
| DERATE FROM $25^\circ\text{C}$ | -1.2       | mW/ $^\circ\text{C}$ |
| OPERATING, STORAGE TEMP        | -40 TO +85 | $^\circ\text{C}$     |
| LEAD SOLDERING TEMP            | +260       | $^\circ\text{C}$     |
| 2.0mm FROM BODY                |            | 3 SEC. MAX           |

\*  $t < 10\mu\text{s}$

**RELIABILITY NOTE**  
OUR MANY YEARS OF EXPERIENCE DATA ACCUMULATION INDICATE THAT SOLDER HEAT IS A MAJOR CAUSE OF EARLY AND FUTURE FAILURE. PLEASE PAY ATTENTION TO YOUR SOLDERING PROCESS.



292 E. HELLEN ROAD  
PALATINE, ILLINOIS 60067  
(708) 359-2790

**CONFIDENTIAL INFORMATION**  
THE INFORMATION CONTAINED IN THIS DOCUMENT IS THE PROPERTY OF LUMEX OPTO/COMPONENTS, INC. EXCEPT AS SPECIFICALLY AUTHORIZED IN WRITING BY LUMEX OPTO/COMPONENTS, INC., THE HOLDER OF THIS DOCUMENT SHALL KEEP ALL INFORMATION CONTAINED HEREIN CONFIDENTIAL AND SHALL PROTECT SAME IN WHOLE OR IN PART FROM DISCLOSURE AND DISSEMINATION TO ALL THIRD PARTIES.

|               |      |        |       |
|---------------|------|--------|-------|
| DATE: 4-10-92 | DWN: | CHK'D: | APPD: |
| SCALE: N/A    |      |        |       |

T-5 (T-1 3/4) FLANGELESS LED,  
YELLOW DIFFUSED

|             |                                 |          |
|-------------|---------------------------------|----------|
| PAGE 1 OF 1 | DRAWING NUMBER<br>SSL-LX509F3YD | REV<br>B |
|-------------|---------------------------------|----------|